

Barbara

#2 / AX B, II

fee is working on the newspaper.

Frank Rooney, the consulting forester, that

in 2010 - I have a letter from

tree growth is due to the removal

Map 1 Lot 2 -

Michael Stavros a property

from Sedgwick Town Office

George @ 221-1255

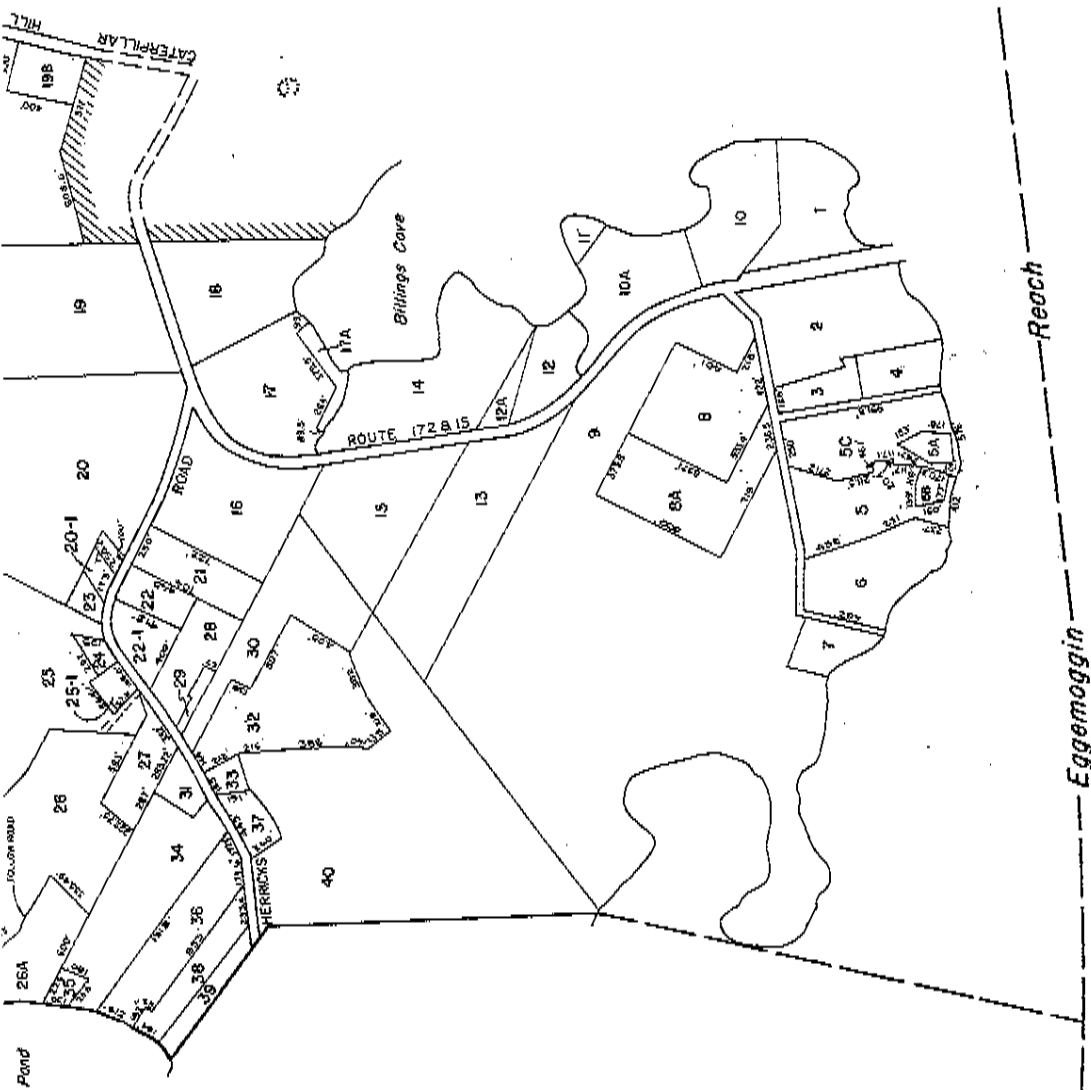

Reach
Eggemoggin

D E E R I S L E

APR 01 2009

PROPERTY MAP
SEDGWICK
HANCOCK COUNTY, MAINE
PREPARED BY
JAMES W. SEWALL COMPANY OLD TOWN, MAINE
SCALE 1 INCH = 500 FEET

K S L I L E